

# City of Napoleon Engineering Department

Office Use Only	
Permit No:	_____
App. Date:	_____
Est. Cost:	_____
Base Fee:	_____
Plus Fee:	_____
Total Fee:	_____

## Application for Sign Permit

Owner Name: ADAPTATION OIL COMPANY

Owner Address: 539 S. MAIN ST., FINDLAY, OH. 45840

Contractor Name: NATIONAL ILLUMINATION & SIGN. CORP.

Contractor Address: 6923 KIRKING DR. PH: (419) 866-1666  
HOLLAND, OH. 43528

Location of Project: 904 SCOTT ST. @ RAILROAD

Additional Information: Sign Type - Post  Wall  Ground  Awning

Dimensions: (3) @ 2'0" x 3'6" = 10.50 sq ft x 3 = 31.50 Total S.F. 31.50  
(2) @ 3'0" x 15'6" = 46.50 sq ft x 2 = 93.00 124.50

Date: 11/19/97 Applicant Signature: [Signature]

Application must include a site drawing or a description of the location of the sign (where applicable) and a sketch of the proposed sign(s).

The permit fee is as follows: \$25.00 base which includes up to 50 square feet of sign area, plus .10 per square foot after 50 square feet, not to exceed \$100.00 in any case.

CANOPY FITS IN SIGNAGE.

ESTIMATED COST = \$6,500.00

$50 \text{ sq ft} =$	<u>25.00</u>
$.10 \text{ per sq ft } 74.50 \text{ sq ft} =$	<u>7.45</u>
<b>TOTAL</b>	<u>32.45</u>

# National Illumination & Sign FAX Transmission

904 Scott

Date: 11/19/97 Pages to follow: 4

To: MR. BRETT DAMMON From: GEORGE JEAKLE  
 Company: CITY OF NAPOLEON Subject: SPEEDWAY SERVL. STR.  
 Address: BUILDINGS ZONING DEPT. SCOTT W. RAILROAD  
 City/State: NAPOLEON, OH. "CANOPY FACIA SIGNAGE"  
 Fax No.: (419) 599-8393 National Fax # ..... (419) 866-5731

IF YOU HAVE PROBLEMS WITH RECEIPT OF THIS TRANSMISSION OR IF THE STATED NUMBER OF PAGES DOES NOT FOLLOW, CALL US @ 419-866-1666

### MESSAGE

RENT. ATTACHED IS A PLOT PLAN SHOWING EXISTING CANOPY OUTLINE 44'-0" X 70'-0" THE HEIGHT OF CANOPY FACIA IS 3'-6"

WHAT SPEEDWAY IS REQUESTING FOR THE CANOPY FACIA IS THREE (3) MOTION "S" LOAD 3'-0" X 3'-6" @ 10.50 SQ FT EACH AND TWO (2) SETS SPEEDWAY CHANNEL LETTERS @ 15'-6" X 3'-0" = 46.50 SQ. FT. EACH.

(A) = MOTION "S" LOAD @ 10.50 ea (B) = LTRS @ 46.50 ea.  
FRONT ELEVATION IS 44'-0" X 3'-6" = 154 SQ. FT.  
COBO ON FRONT IS 10.50 SQ. FT. ON 154 SQ. FT AREA.

DATE SENT: \_\_\_\_\_ BY: \_\_\_\_\_

### RESPONSE

SIDE ELEVATIONS ARE 70'-0" X 3'-6" = 252.00 SQ FT ea.  
INSTALL 1-SET LTRS W/ 1000 EA. SIDE = TOTAL 52.00 SQ. FT PER SIDE ELEVATION.

SITE/PLOT PLAN IS MARKED FOR LOCATIONS OF COBOS - "A", LETTERS - "B"

PLEASE LET ME KNOW IF THE SIGNAGE IS OK AND AMOUNT OF PERMITS.

RESPONSE DATE: 11/19/97 BY: George Jeakle

THANKS  
419-599-8393

36"x12" moving "S" canopy logo sign

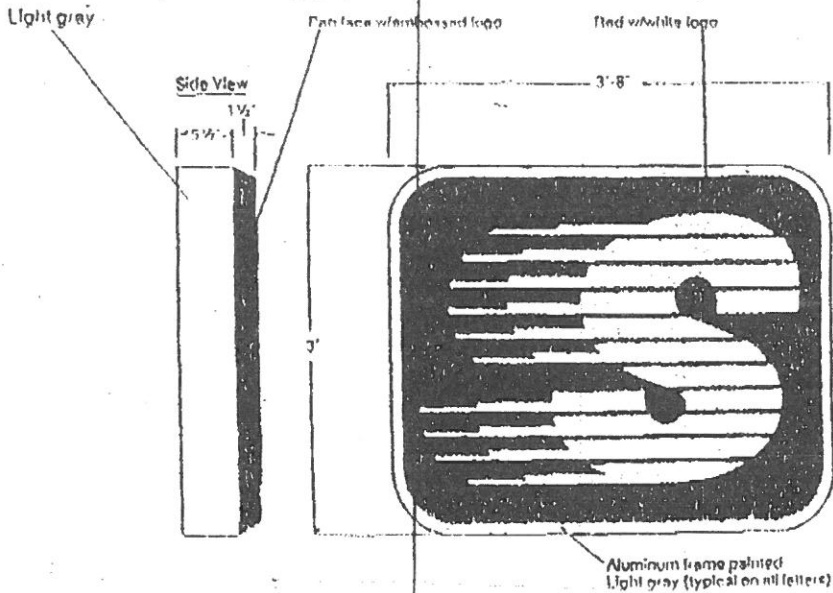
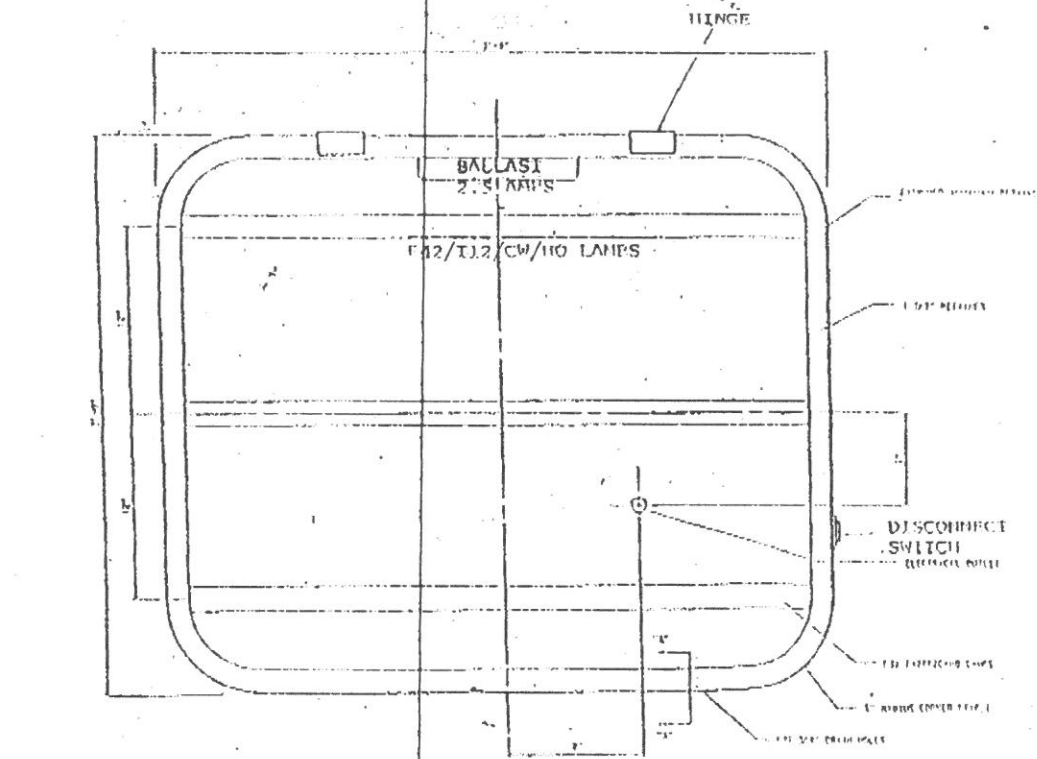

MEMORIT

*Matson "S" logo (A)*

SQUARE CORNER & RADIUS-CORNER  
 LETTER(S) / LOGO(S) LAYOUT ON CANOPY DETAIL  
 EXACT LOCATION PER PLOT PLAN  
 ALLOW FOR RED STRIPE IF NOT ALREADY APPLIED

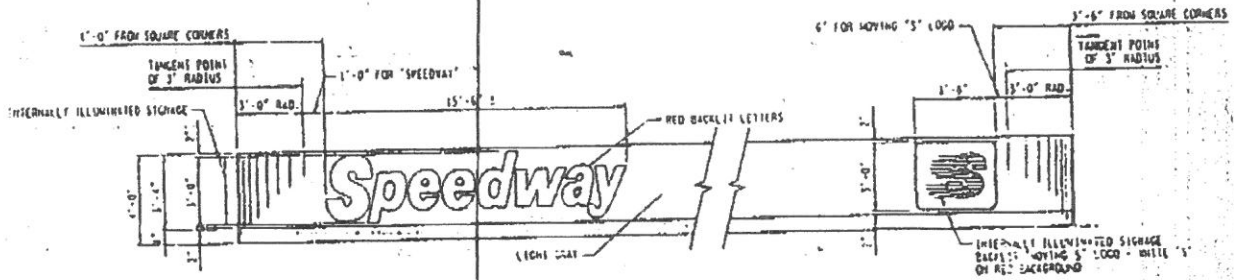
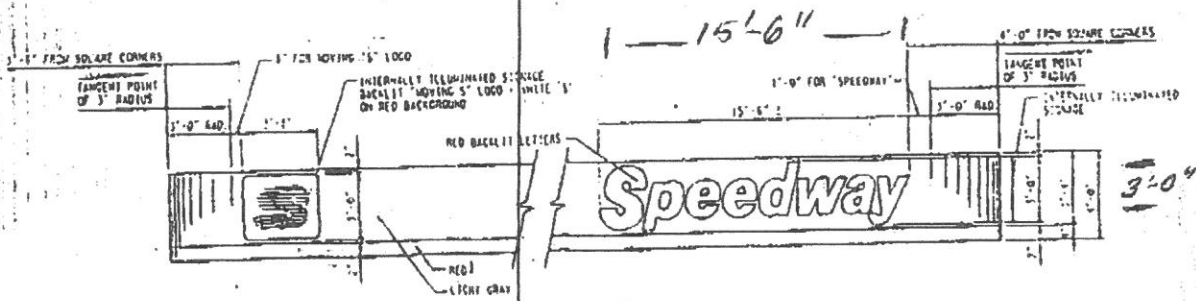

*Speedway letters (B)*

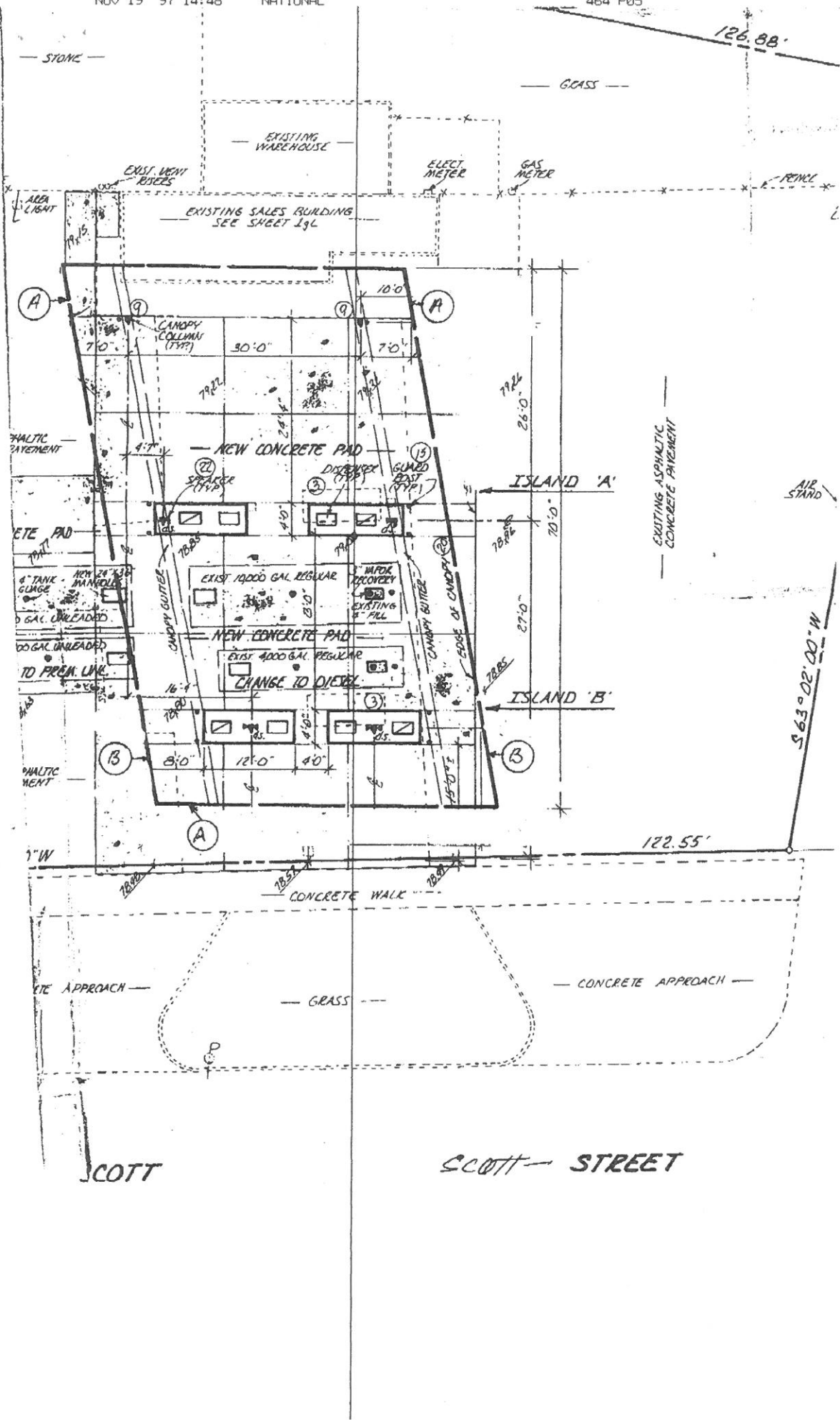

SCOTT

SCOTT STREET